

**FOUNDATION PLAN**  
1/4"=1'

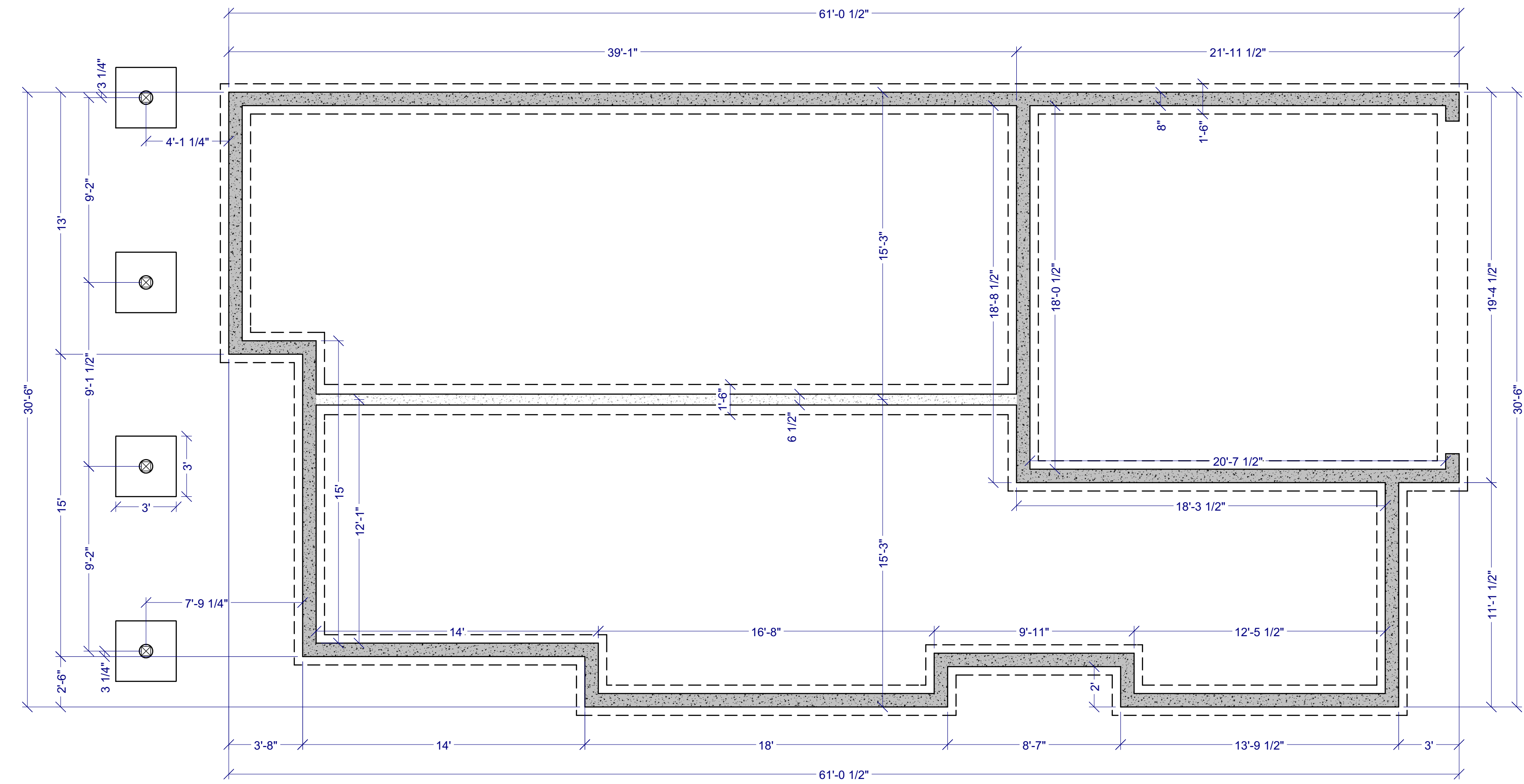

**FOUNDATION NOTES**

1. FOUNDATIONS TO BEAR A MINIMUM OF 36" BELOW GRADE TO PROTECT FROM FROST.
2. ALL FOOTINGS MUST BEAR ON UNDISTURBED SOIL OR COMPACT GRANULAR FILL.
3. ADJACENT GROUND SURFACES SHALL BE SLOPED AWAY FROM STRUCTURE.
4. FOUNDATION WALLS SHALL EXTEND NO LESS THAN 8" ABOVE GRADE.
5. 8" SONO-TUBE USED TO FORM COLUMNS FOR POSTS.
6. FOOTING SIZES UNO - 8" thick walls 18" wide x 8" thick, 10" thick walls 24" wide x 8" thick
7. BACKFILL SHALL NOT BE PLACED AGAINST THE FOUNDATION WALL UNTIL THE CONCRETE HAS REACHED ITS SPECIFIED 28" DAY STRENGTH AND UNTIL THE STRUCTURAL FLOOR FRAMING IS IN PLACE, INCLUDING SUBFLOOR.
8. CONCRETE STRIP FOOTINGS 18" x 8" CONT CONC FOOTING W/ 2-15M REBARS CONT (OR AS PER ENGINEER)
9. FOUNDATION WALLS 8" / 10" CONCRETE FOUNDATION 1/2" DIA ANCHOR BOLTS @ 48" O.C.
10. ON-SITE CONDITIONS WILL DETERMINE FINAL DIMENSIONS.
11. CONTRACTOR TO CONFIRM ALL ELEVATIONS AND MEASUREMENTS.

SHEET NUMBER  
**5**

SCALE @ 24" X 36"  
1/4" = 1'  
APRIL 23, 2024



**FOUNDATION PLAN**

30 - 2715 GOLF COURSE DRIVE  
**HOBART CONSTRUCTION LTD.**

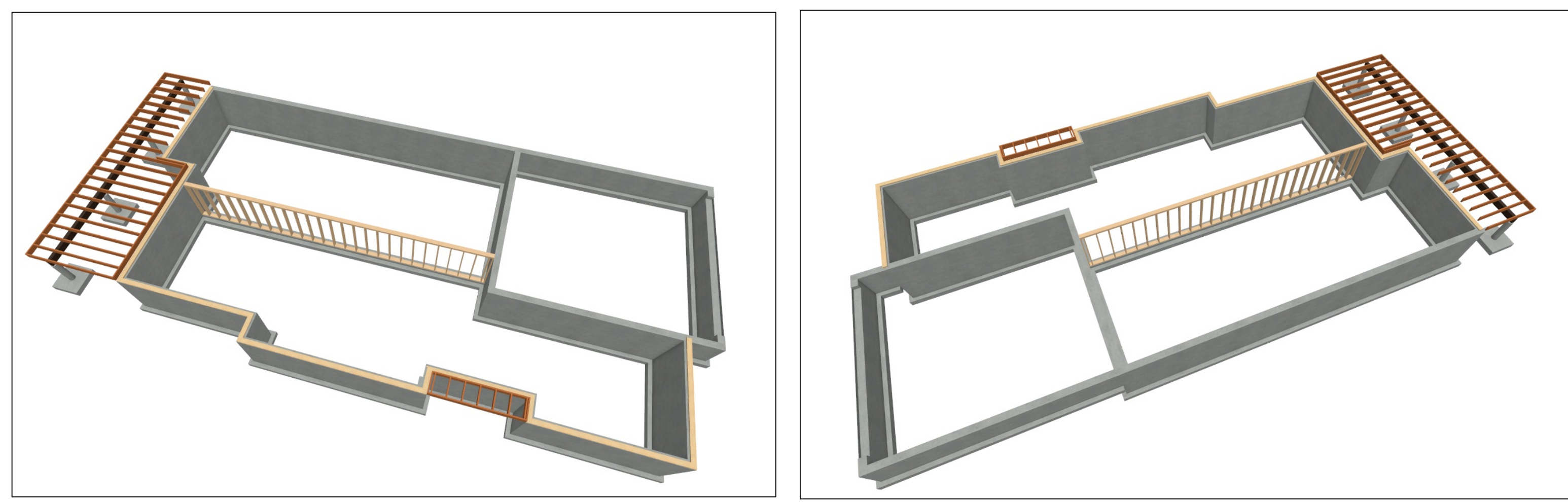
**OVERVIEW RENDERING**  
FOR ILLUSTRATION ONLY NO SCALE

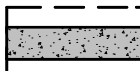

**WALL LEGEND**

-  8" CONCRETE WALL
-  2 x 6 EXTERIOR HARDY PLANK GARAGE

**ARNOLD BAYER**  
RESIDENTIAL DRAFTING & DESIGN  
Phone 604-989-9587 / amoldbayer@elius.net

